

## Introduction:



1. Be used in area of automatic control, measurements, robotics, X-Y labor and printing.
2. It is highly reliable, long life and has strong anti-interference ability. Wide range temperature adaptation.
3. customized wide range of temperature adaptation, IP rating, etc.

## Wiring Table

Signal	A+	B+	Z+	A-	B-	Z-	Vcc	GND
Color	Green	White	Yellow	Brown	Gray	Orange	Red	Black

## Mechanical Spec.

Max. Shaft Speed(r/min)	Starting Torque	Max. Shaft Loading	Shocking	Vibration
5000	<0.03Nm	Radial: 15N, Axial: 10N	50G/11ms	10G10-2000Hz
Rotor Inertia	Operating Temperature	Storage Temperature	Protection	Weight
4×10 kgm	-30°C~85°C	-35°C~95°C	IP51	100g

## Dimension

(unit: mm [1inch=25.4mm])

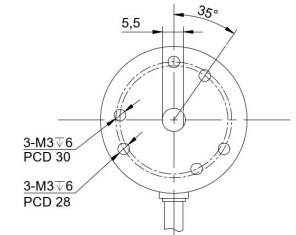
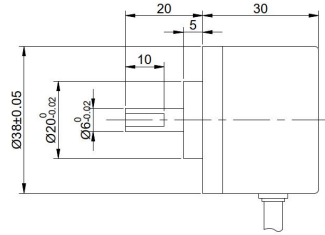

3-M3×6  
PCD 30  
3-M3×6  
PCD 28