

P VIEW

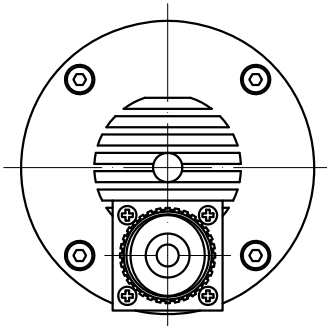

SPECIFICATION	VALUE
POWER (Kw)	2.2
VOLTAGE (VAC)	220
RATED CURRENT (A)	8
MAXIMUM SPEED (RPM)	24000
FREQUENCY (Hz)	400
NUT MODEL	ER20
COLLET (mm)	Ø6
COOLING	AIR COOLED
MATERIAL	STAINLESS STEEL
LUBRICATION	GREASE
WEIGHT (Kg) [lb]	4.75 [10.47]



mm	APVD		7.11.2022
UNIT	CHKD		
2:1	DRN		
SCALE	SIGNATURE		DATE

SPINDLE MOTOR

GDZ80F-2.2B4

