

SPECIFICATION	CONNECTION	VALUE
GEAR RATIO		10
EFFICIENCY		90.00%
BACKLASH@NO-LOAD(arcmin)		<=30
MAX.PERMISSIBLE TORQUE(Nm)[lb-in]		10.00[88.51]
SHAFT MAXIMUM AXIAL LOAD(N)		200
SHAFT MAXIMUM RADIAL LOAD(N)		400
GEARBOX MATCHING MOTOR'S INPUT SHAFT LENGTH (mm)		13.5±0.5
RATED INPUT SPEED(RPM)		1000
MAX. INPUT SPEED(RPM)		2000
NOISE(dB)		<=60
WATERPROOF RATING		IP54
WORKING TEMPERATURE		-20°C~150°C[-4°F~302°F]

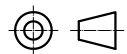

**STEPPERONLINE®**

	APVD		12.7.2022
	CHKD		
2:3	DRN		
SCALE	SIGNATURE		DATE

**PLANETARY GEARBOX**

**MG23-G10-D8**