

CUSTOMER'S MODEL: NO MODEL
 END COVER COLOR: BLACK

REV.	REVISION RECORD	BY	DATE
0	ORIGIN	MYX	10.8.2025

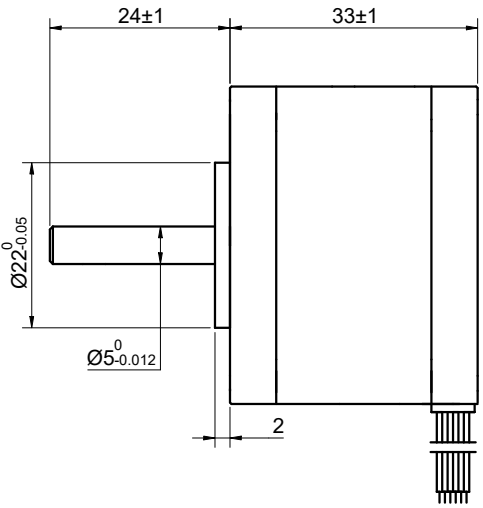
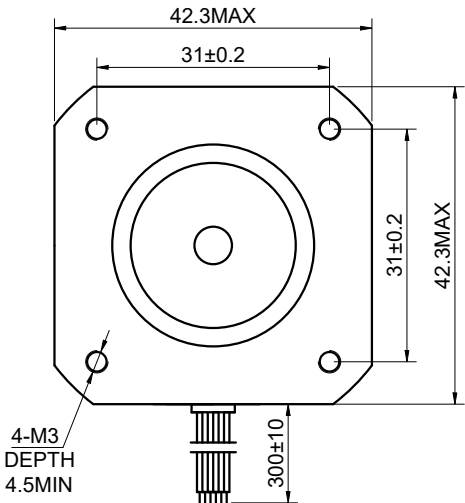

MOTOR CONNECTION			
PIN NO	BIPOLAR	LEADS	WINDING
1	A+	BLK	
2	A-	GRN	
3	B+	RED	
4	B-	BLU	
5	O+	YEL	
6	O-	WHT	

SPECIFICATION	CONNECTION	UNIPOLAR
AMPS/PHASE		0.31
RESISTANCE/PHASE(Ohms)@25°C		38.50±10%
INDUCTANCE/PHASE(mH)@1KHz		21.00±20%
HOLDING TORQUE(Nm)[lb-in]		0.16[1.37]
STEP ANGLE(°)		1.80
STEP ACCURACY(NON-ACCUM)		±5.00%
ROTOR INERTIA(g-cm ²)		35.00
WEIGHT(Kg)[lb]		—
AMBIENT TEMPERATURE		-10°C~50°C[14°F~122°F]
INSULATION CLASS		B 130°C[266°F]
TEMPERATURE RISE		MAX.80°C

COMMENT:
 1.DYNAMIC AXIAL LOAD: 10N MAX
 2.DYNAMIC RADIAL LOAD @ SHAFT LENGTH 20mm: 21N MAX
 3.TMBF 6000h OR MORE @ 24V/300RPM
 4.INSULATION RESISTANCE (NORMAL TEMPERATURE AND HUMIDITY): 100 Mohm
 5.DIELECTRIC STRENGTH 500VAC FOR 1MIN.(BETWEEN THE MOTOR COILS AND THE MOTOR CASE)

FULL STEP 2 PHASE-Ex.,WHEN FACING MOUNTING END (X)							DIMENSIONS ARE IN MILLIMETERS.	
STEP	A+	B+	A-	B-	O(O)		CCW	TOLERANCES AS BELOW:
								DECIMALS
1	-	-			+			ANGLES ±2°
2					+		X ±0.5	
3					+		X.X ±0.25	
4	-				+		X.XX ±0.13	
							THIRD ANGLE PROJECTION	

STEPPERONLINE®

STEPPER MOTOR

17HS13-0316S

REV.	0	SCALE	1:1	DWG NO.	A0569
------	---	-------	-----	---------	-------

SIGNATURE		DATE
DRN	MYX	10.8.2025
APVD	LJ	10.8.2025