

CUSTOMER'S MODEL: NO MODEL
END COVER COLOR: BLACK

| REV. | REVISION RECORD | BY | DATE |
|------|-----------------|-----|-----------|
| 0 | ORIGIN | ZPJ | 12.1.2025 |

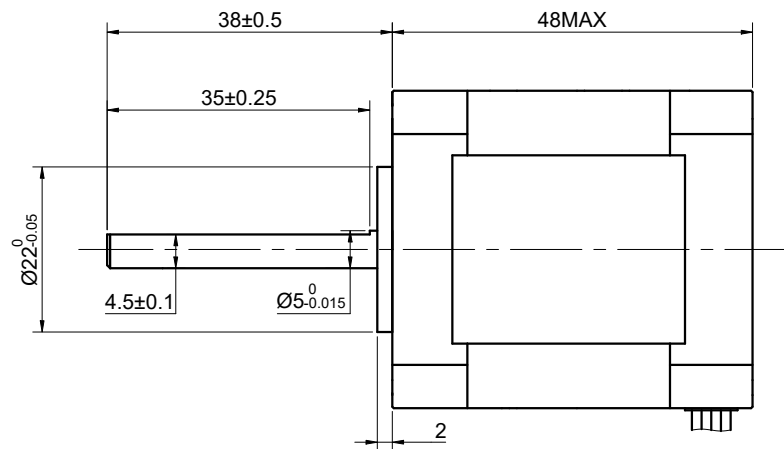
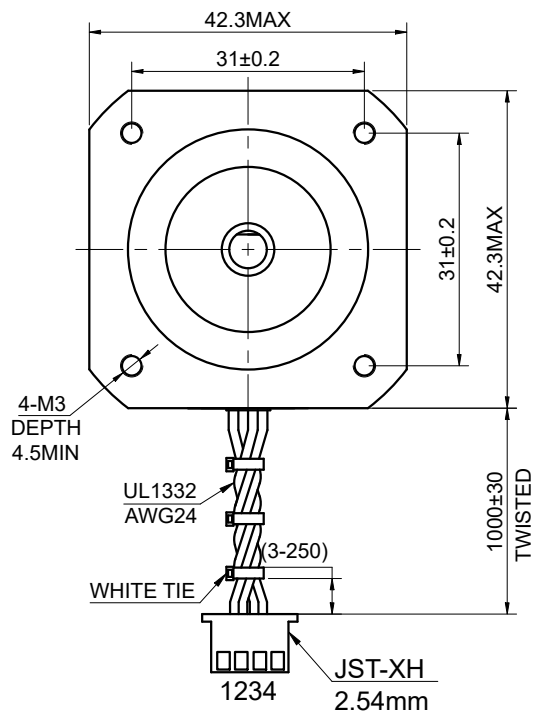

| SPECIFICATION | CONNECTION | BIPOLAR |
|-----------------------------------|------------|------------------------|
| AMPS/PHASE | | 2.50 |
| RESISTANCE/PHASE(Ohms)@25°C | | 1.10±10% |
| INDUCTANCE/PHASE(mH)@1KHz | | 1.60±20% |
| HOLDING TORQUE(Nm)[lb-in] | | 0.55[4.87] |
| STEP ANGLE(°) | | 1.80 |
| STEP ACCURACY(NON-ACCUM) | | ±5.00% |
| ROTOR INERTIA(g-cm ²) | | 68.00 |
| WEIGHT(Kg)[lb] | | — |
| AMBIENT TEMPERATURE | | -10°C~50°C[14°F~122°F] |
| INSULATION CLASS | | H 180°C[356°F] |
| TEMPERATURE RISE | | MAX.125°C |

COMMENT:
 1.DYNAMIC AXIAL LOAD: 10N MAX
 2.DYNAMIC RADIAL LOAD @ SHAFT LENGTH 20mm: 21N MAX
 3.TMBF 6000h OR MORE @ 24V/300RPM
 4.INSULATION RESISTANCE
 (NORMAL TEMPERATURE AND HUMIDITY): 100 Mohm
 5.DIELECTRIC STRENGTH 500VAC FOR 1MIN.(BETWEEN THE MOTOR COILS AND THE MOTOR CASE)

| STEP | A+ | B+ | A- | B- |
|------|----|----|----|----|
| 1 | + | + | - | - |
| 2 | - | + | + | - |
| 3 | - | - | + | + |
| 4 | + | - | - | + |

FULL STEP 2 PHASE-Ex.,WHEN FACING MOUNTING END (X)
 DIMENSIONS ARE IN MILLIMETERS.
 TOLERANCES AS BELOW:
 DECIMALS ANGLES
 X ±0.5 ±2°
 X.X ±0.25
 X.XX ±0.13
 THIRD ANGLE PROJECTION



| MOTOR CONNECTION | | | |
|------------------|---------|-------|---------|
| PIN NO | BIPOLAR | LEADS | WINDING |
| 1 | A+ | GRY | |
| 2 | A- | BRN | |
| 3 | B+ | ORG | |
| 4 | B- | YEL | |

STEPPERONLINE®

STEPPER MOTOR

17HS19-2504S-H-V6

| SIGNATURE | | DATE |
|-----------|-----|-----------|
| DRN | ZPJ | 12.1.2025 |
| APVD | LDJ | 12.1.2025 |