

| REV. | REVISION RECORD | BY  | DATE      |
|------|-----------------|-----|-----------|
| 0    | ORIGIN          | ZPJ | 10.9.2025 |

CUSTOMER'S MODEL: NO MODEL  
 END COVER COLOR: BLACK

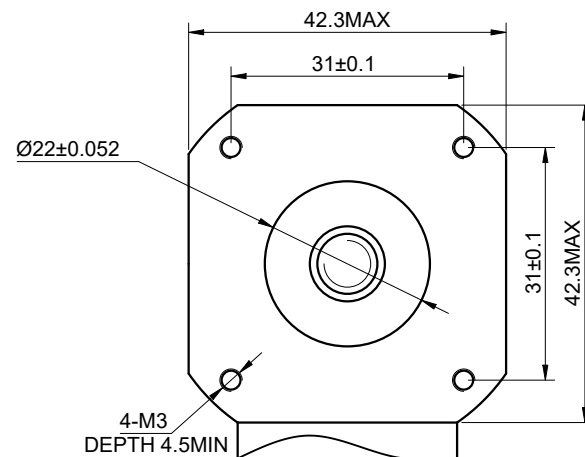
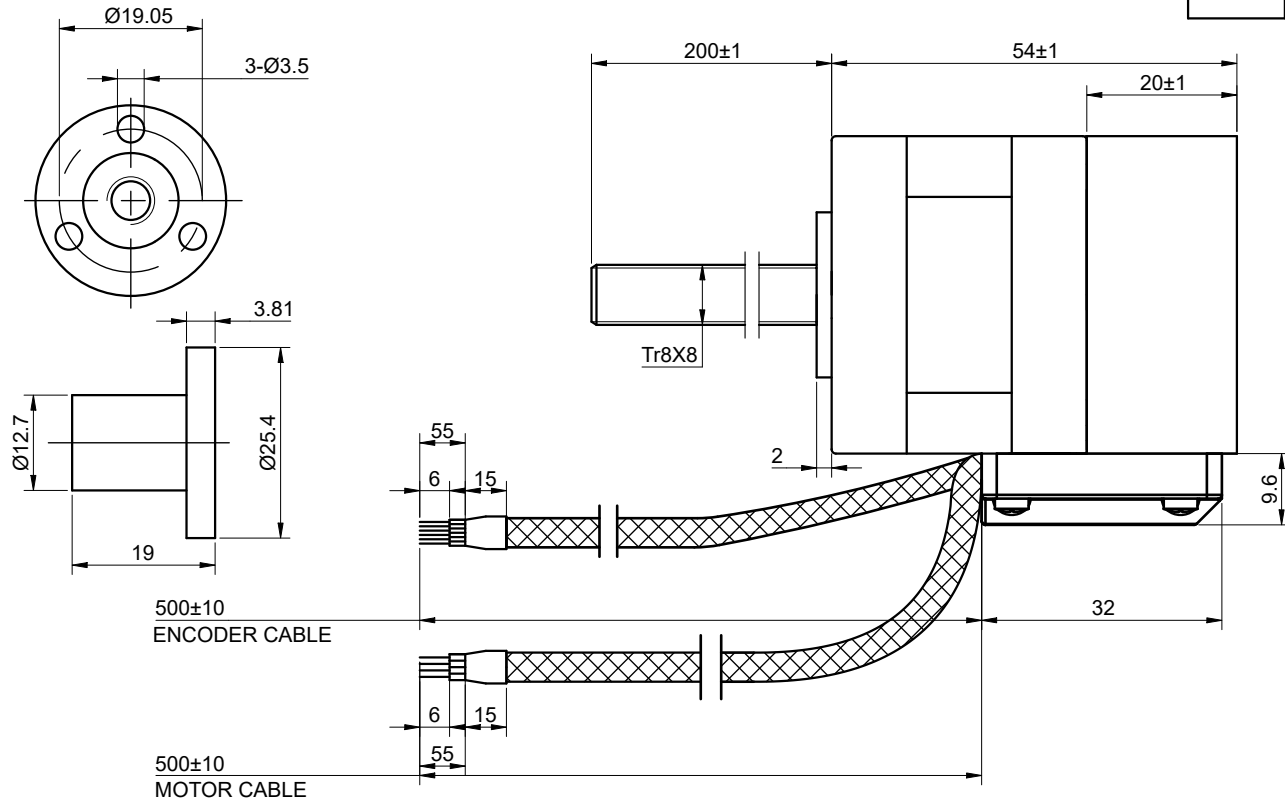

|                                     |     |     |     |     |     |     |
|-------------------------------------|-----|-----|-----|-----|-----|-----|
| ENCODER RESOLUTION:1000PPR(4000CPR) |     |     |     |     |     |     |
| LEAD COLOR                          | RED | WHT | BLK | BLU | YEL | GRN |
| DESCRIPTION                         | VCC | GND | EA+ | EA- | EB+ | EB- |

| MOTOR CONNECTION |         |       |         |
|------------------|---------|-------|---------|
| PIN NO           | BIPOLAR | LEADS | WINDING |
| 1                | A+      | BLK   |         |
| 2                | A-      | GRN   |         |
| 3                | B+      | RED   |         |
| 4                | B-      | BLU   |         |

| SPECIFICATION               | CONNECTION | BIPOLAR                |
|-----------------------------|------------|------------------------|
| AMPS/PHASE                  |            | 1.68                   |
| RESISTANCE/PHASE(Ohms)@25°C |            | 1.15±10%               |
| INDUCTANCE/PHASE(mH)@1KHz   |            | 1.60±20%               |
| HOLDING TORQUE(Nm)[lb-in]   |            | 0.26[2.30]             |
| STEP ANGLE(°)               |            | 1.80                   |
| STEP ACCURACY(NON-ACCUM)    |            | ±5.00%                 |
| LEAD(mm)                    |            | 8.00                   |
| LINEAR TRAVEL/STEP(mm)      |            | 0.04                   |
| AMBIENT TEMPERATURE         |            | -10°C~50°C[14°F~122°F] |
| INSULATION CLASS            |            | B 130°C[266°F]         |
| TEMPERATURE RISE            |            | MAX.80°C               |
| AMBIENT HUMIDITY            |            | MAX.85%                |

COMMENT:  
 1.TMBF 6000h OR MORE @ 24V/300RPM  
 2.INSULATION RESISTANCE (NORMAL TEMPERATURE AND HUMIDITY): 100 Mohm  
 3.DIELECTRIC STRENGTH 500VAC FOR 1MIN.(BETWEEN THE MOTOR COILS AND THE MOTOR CASE )



|  |    |    |    |    |     |  |
|--|----|----|----|----|-----|--|
| FULL STEP 2 PHASE-Ex.,WHEN FACING MOUNTING END (X) |    |    |    |    |     | DIMENSIONS ARE IN MILLIMETERS.<br>TOLERANCES AS BELOW:<br>DECIMALS ANGLES<br>X ±0.5<br>X.X ±0.25<br>X.XX ±0.13<br>THIRD ANGLE PROJECTION |
| STEP   | A+ | B+ | A- | B- | CCW |  |
| 1  | +  | +  | -  | -  |     |  |
| 2  | -  | +  | +  | -  |     |  |
| 3  | -  | -  | +  | +  |     |  |
| 4  | +  | -  | -  | +  |     |  |

THIS DOCUMENT SHALL NOT BE REPRODUCED NOR SHALL THE INFORMATION CONTAINED HEREIN BE USED BY OR DISCLOSED TO OTHERS UNLESS EXPRESSLY AUTHORIZED IN BY WRITING STEPPERONLINE.

|           |     |           |
|-----------|-----|-----------|
| SIGNATURE |     | DATE      |
| DRN       | ZPJ | 10.9.2025 |
| APVD      | LJ  | 10.9.2025 |

**STEPPERONLINE®**

**STEPPER MOTOR**

**17E13S1684MB4-200RS-OE1K**