

CUSTOMER'S MODEL: NO MODEL
END COVER COLOR: BLACK

REV.	REVISION RECORD	BY	DATE
0	ORIGIN	LJ	8.12.2025

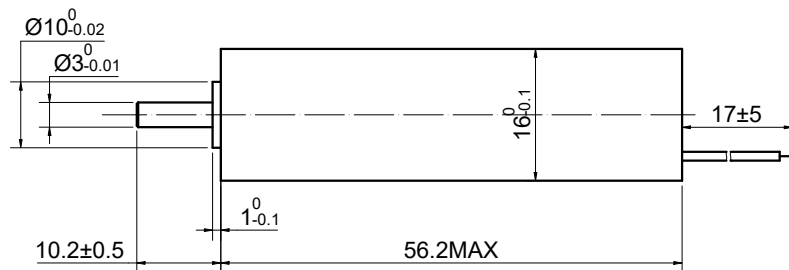
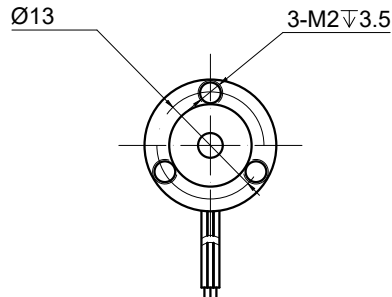

SPECIFICATION	VALUE
RATED VOLTAGE(V)	24
TERMINAL RESISTANCE(Ohms)	1.3
TERMINAL INDUCTANCE(mH)	0.07
NO LOAD SPEED(RPM)	40000
NO LOAD CURRENT(A)	0.12
RATED SPEED(RPM)	32000
RATED CURRENT(A)	1.79
RATED TORQUE(mNm)	10.2
RATED POWER(W)	34.18
THE GREATEST POWER OUTPUT(W)	109.33
EFFICIENCY(%)	84.53
TORQUE CONSTANT (mNm/A)	5.69
STALL TORQUE (mNm)	104.41
BACK-EMF CONSTANT (mV/RPM)	0.6
SPEED CONSTANT(RPM/V)	1677.57
FRICTION TORQUE(mNm)	0.68
CURRENT CONSTANT(A/mNm)	0.18

1. OPERATING TEMPERATURE RANGE: -20°C~80°C[-4°F~176°F] 2. WIN ING MAX PERMISSIBLE: 180°C[356°F] 3. NO. of POLES: 2	DIMENSIONS ARE IN MILLIMETERS. TOLERANCES AS BELOW: DECIMALS ANGLES X ±0.5 ±2° X.X ±0.25 XXX ±0.13	
	THIRD ANGLE PROJECTION	
THIS DOCUMENT SHALL NOT BE REPRODUCED NOR SHALL THE INFORMATION CONTAINED HEREIN BE USED BY OR DISCLOSED TO OTHERS UNLESS EXPRESSLY AUTHORIZED IN BY WRITING STEPPERONLINE.	SIGNATURE	DATE
	DRN LJ	8.13.2025
	APVD YSX	8.13.2025

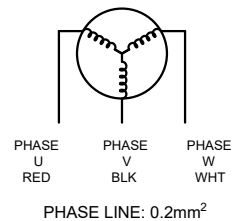

STEPPERONLINE®									
BRUSHLESS DC MOTOR									
16CL56-24-P2-32000									
REV.	0	SCALE	1:1	DWG NO.	A4870				