

REV.	REVISION RECORD	BY	DATE
0	ORIGIN	LDJ	7.8.2024

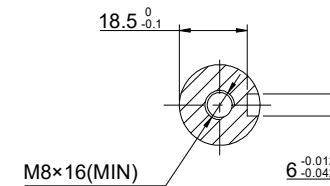
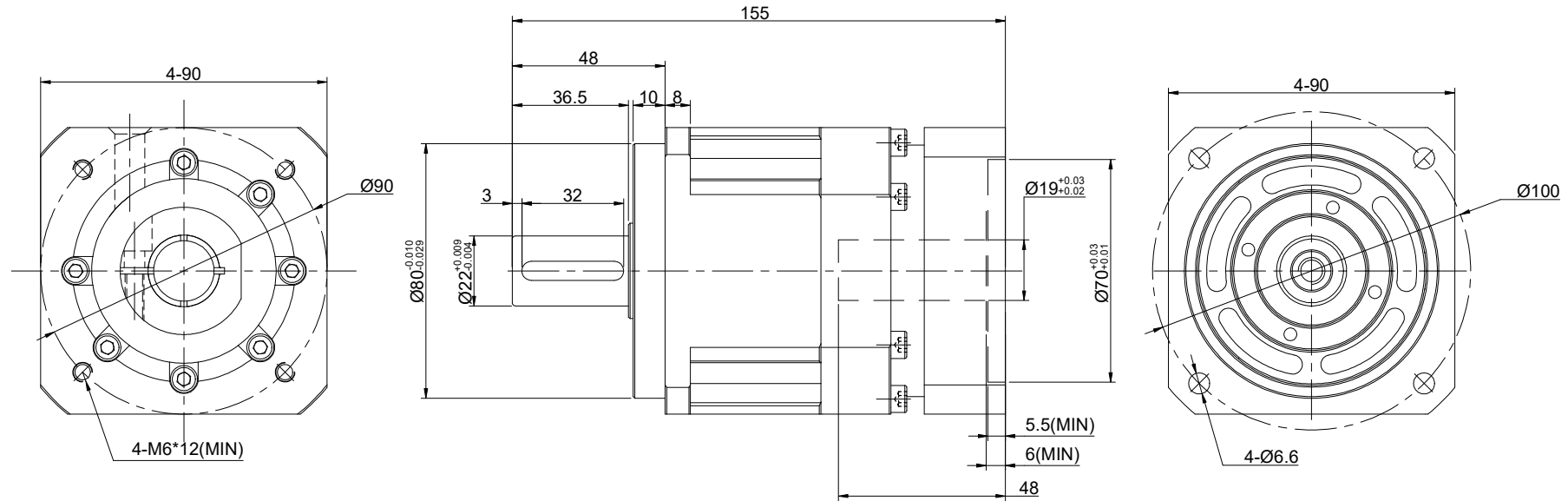

SPECIFICATION	CONNECTION	VALUE
GEAR RATIO		5
EFFICIENCY		97%
BACKLASH@NO-LOAD(arcmin)		5
MAX.PERMISSIBLE TORQUE(Nm)[lb-in]		130.00[1150.6]
MOMENT PERMISSIBLE TORQUE(Nm)[lb-in]		390.00[3451.79]
SHAFT MAXIMUM AXIAL LOAD(N)		1625
SHAFT MAXIMUM RADIAL LOAD(N)		3250
GEARBOX MATCHING MOTOR'S INPUT SHAFT LENGTH (mm)		48MAX
RATED INPUT SPEED(RPM)		3000
MAX. INPUT SPEED(RPM)		6000
WEIGHT(KG)		3.7
WATERPROOF RATING		IP65
LIFE(h)		20000
WORKING TEMPERATURE		-10°C~+90°C[14°F~194°F]

DIMENSIONS ARE IN MILLIMETERS.
TOLERANCES AS BELOW:
DECIMALS ANGLES
X ±0.5 ±2°
X.X ±0.25
X.XX ±0.13

THIRD ANGLE PROJECTION		
SIGNATURE		DATE
DRN	LDJ	7.8.2024
APVD	HW	7.8.2024

STEPPERONLINE®									
GEARBOX									
AB90-G5-D19									
REV.	1	SCALE	1:1	DWG NO.	A3436				