

REV.	REVISION RECORD	BY	DATE
0	ORIGIN	LDJ	12.16.2025

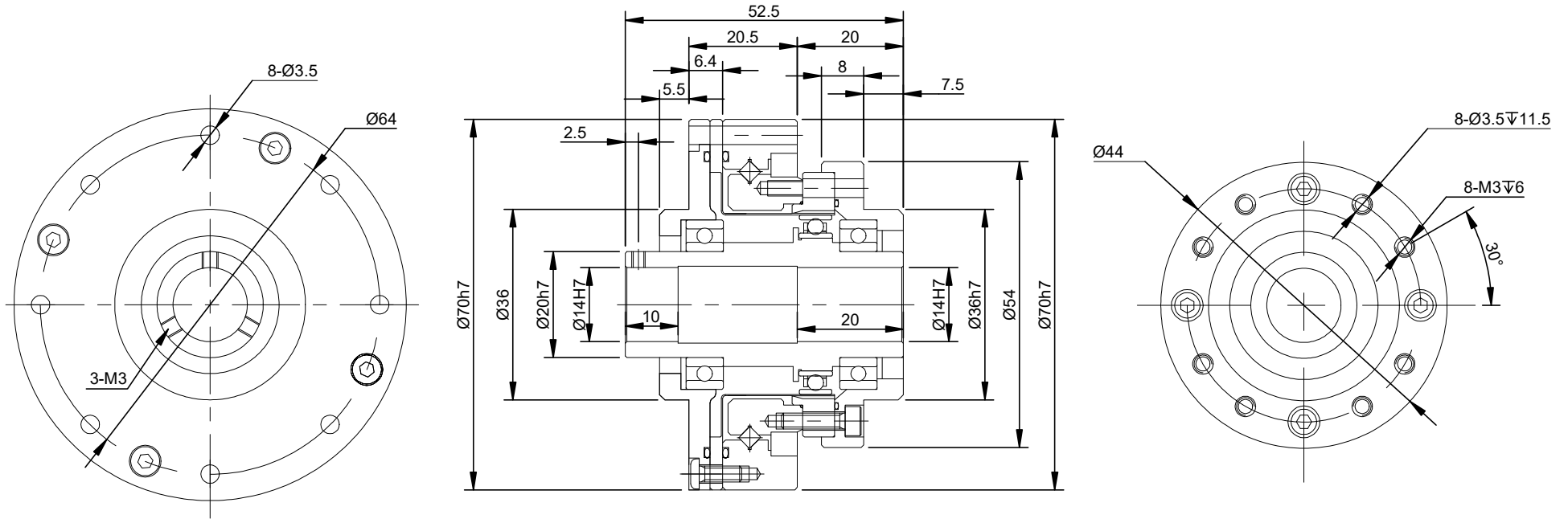

SPECIFICATION	CONNECTION	VALUE
GEAR RATIO		100
BACKLASH@NO-LOAD(arcsec)		≤ 20
RATED TORQUE(INPUT SPEED 2000RPM)(Nm)[lb-in]		10.00[88.51]
MOMENT PERMISSIBLE TORQUE(Nm)[lb-in]		70.00[619.55]
PEAK START-STOP TORQUE(Nm)[lb-in]		36.00[318.63]
MAXIMUM INPUT SPEED ALLOWED(RPM)		8500
AVERAGE INPUT SPEED ALLOWED(RPM)		3500
WEIGHT(kg)		0.70
LIFE(h)		15000
AMBIENT TEMPERATURE		$0^\circ\text{C}\sim 40^\circ\text{C}[32^\circ\text{F}\sim 104^\circ\text{F}]$

DIMENSIONS ARE IN MILLIMETERS.
TOLERANCES AS BELOW:
DECIMALS ANGLES
X ± 0.5 $\pm 2^\circ$
X.X ± 0.25
X.XX ± 0.13

THIRD ANGLE PROJECTION

SIGNATURE DATE

DRN LDJ 12.23.2025

APVD ZPJ 12.23.2025

STEPPERONLINE®

HARMONIC REDUCER

HHT-14-100-III-D14

REV.	0	SCALE	1:1	DWG NO.	A3340
------	---	-------	-----	---------	-------