

P.C.D Ø31
6-M3 depth 7mm MAX.

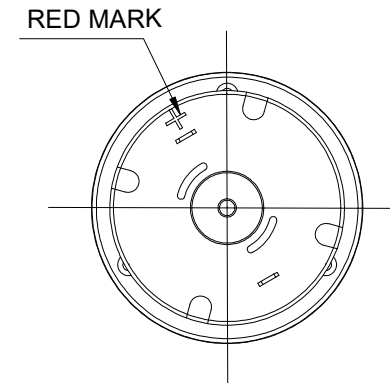
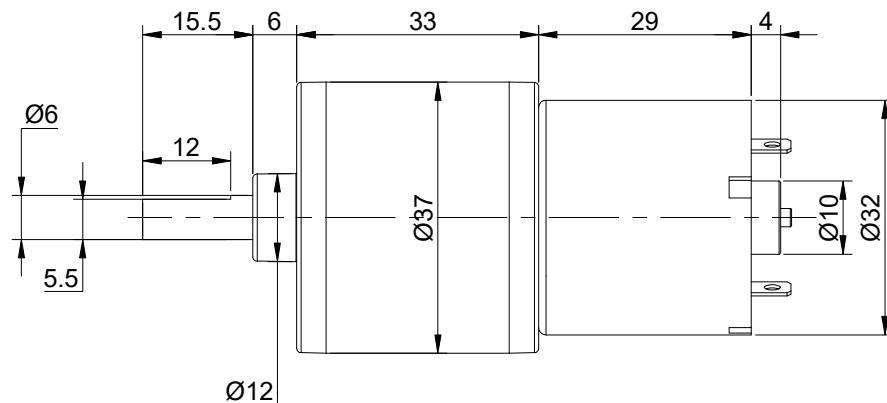

SPECIFICATION	CONNECTION	VALUE
RATED VOLTAGE(V):		12
NO LOAD CURRENT(mA):		≤150
NO LOAD SPEED(RPM):		54±5
RATED LOAD TORQUE(kgf.cm):		6
RATED CURRENT(mA):		≤1000
RATED LOAD SPEED(RPM):		40±4
STALL CURRENT(mA):		—
STALL TORQUE(kgf.cm):		—
ROTATION DIRECTION		CW/CCW

NOTES:

- PLEASE CONDUCT THE WELDING WORK IN A SHORT TIME.(RECOMMENDATION:WITH THE SOLDERING IRON TIP AT A TEMPERATURE OF 340~400℃, WITHIN 2 SECONDS.
- PREVENT GEAR MOTOR FROM BEING SHOCKED OR DROPPING IN MOUNTING PROCESS.IT IS PROHIBITED TO STRIKE AND CRUSH DIRECTLY ON REDUCER OUTPUT SHAFT.
- INSTALL THE SCREWS AFTER FIRST CHECKING THE TAPS AND TAP DEPTH AGAINST THE DIMENSIONS ENTERED ON THE EXTERIOR DRAWING.
- IT IS NECESSARY TO BE CAREFUL THAT THE ADHESIVE DOES NOT SPREAD ALONG THE SHAFT AND FLOW INTO THE BEARING.
- DO NOT TURN A GEARED MOTOR BY ITS OUTPUT SHAFT WHEN,FOR EXAMPLE,ARRANGING ITS POSITION SO AS TO INSTALL IT.

STEPPERONLINE®

	APVD		9.22.2025
	CHKD		
1:1	DRN		
SCALE	SIGNATURE		DATE

DC GEARBOX MOTOR

SGF37-32127000-G128