

REV.	REVISION RECORD	BY	DATE
0	ORIGIN	LJ	7.31.2025

CUSTOMER'S MODEL: NO MODEL
 END COVER COLOR:

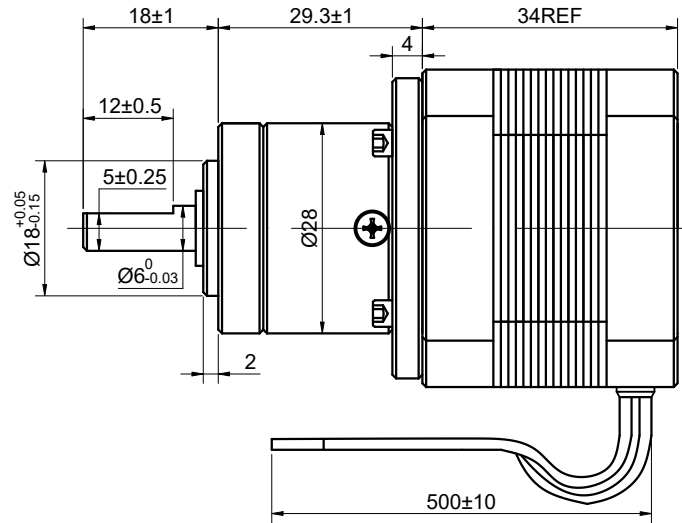
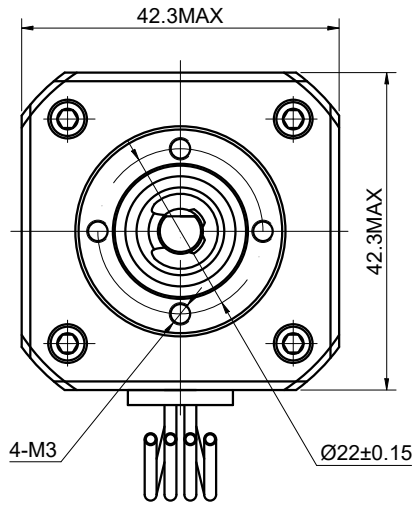

SPECIFICATION	CONNECTION	BIPOLAR
AMPS/PHASE		0.40
RESISTANCE/PHASE(Ohms)@25°C		30.00±10%
INDUCTANCE/PHASE(mH)@1KHz		27.00±20%
HOLDING TORQUE w/o GEARBOX(Nm)[lb-in]		0.22[1.95]
STEP ANGLE w/o GEARBOX(°)		1.80±5.00%
GEAR RATIO		5 _{fl}
MAX.PERMISSIBLE TORQUE(Nm)		2.00
MOMENT PERMISSIBLE TORQUE(Nm)		4.00
EFFICIENCY		90%
BACKLASH@NO-LOAD(arcmin)		<=60
LIFE(h)		6000
AMBIENT TEMPERATURE		-10°C~50°C[14°F~122°F]
INSULATION CLASS		B 130°C[266°F]
TEMPERATURE RISE		MAX.80°C

COMMENT:
 1.TMBF 6000h OR MORE @ 24V/300RPM
 2.INSULATION RESISTANCE (NORMAL TEMPERATURE AND HUMIDITY): 100 Mohm
 3.DIELECTRIC STRENGTH 500VAC FOR 1MIN.(BETWEEN THE MOTOR COILS AND THE MOTOR CASE)

STEPPER MOTOR
 MODEL:17HS13-0404S-CG5
 S/N: XXXXXXXXXXXXX



MOTOR CONNECTION(EHR-6)			
PIN NO	BIPOLAR	LEADS	WINDING
1	A+	BLK	
2	A-	GRN	
3	B+	RED	
4	B-	BLU	

FULL STEP 2 PHASE-Ex.,WHEN FACING MOUNTING END (X)					DIMENSIONS ARE IN MILLIMETERS. TOLERANCES AS BELOW:	
STEP	A+	B+	A-	B-	CW	CCW
1	+	+	-	-		DECIMALS: X ±0.5, X.X ±0.25, X.XX ±0.13 ANGLES: ±2°
2	-	+	+	-		
3	-	-	+	+		
4	+	-	-	+		

STEPPERONLINE®

STEPPER MOTOR

17HS13-0404S-CG5

SIGNATURE		DATE
DRN	LJ	7.31.2025
APVD	YSX	7.31.2025