

CUSTOMER'S MODEL: NO MODEL
 END COVER COLOR: BLACK

REV.	REVISION RECORD	BY	DATE
0	ORIGIN	ZPJ	7.30.2025

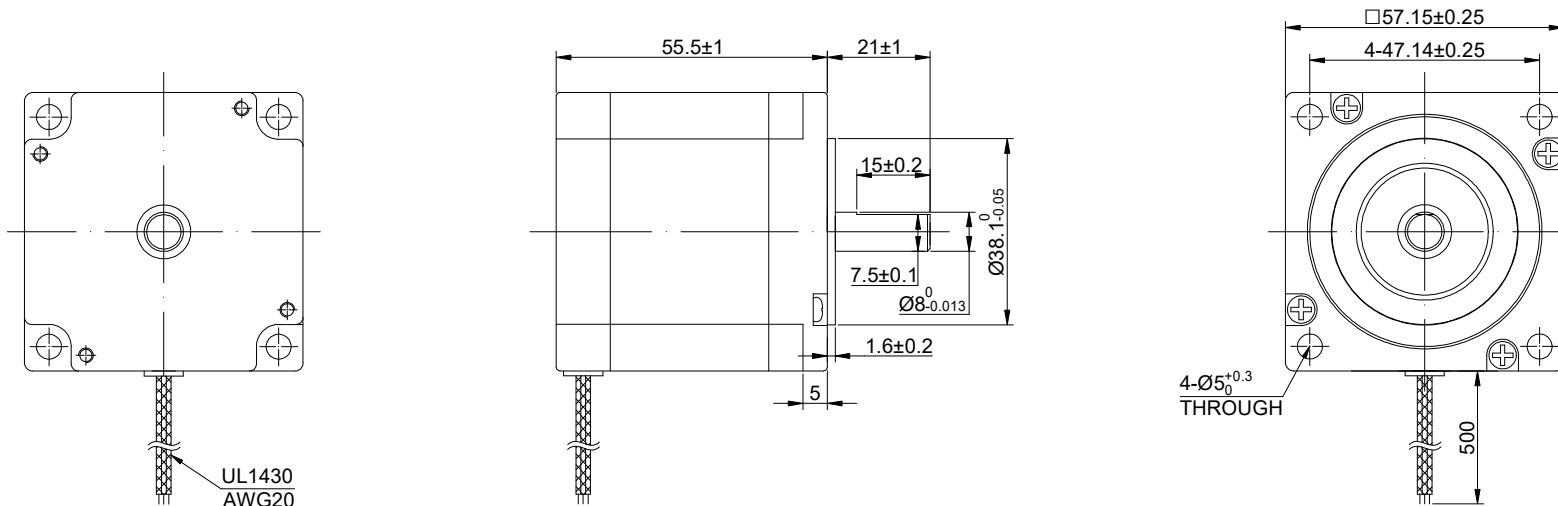

UL1430
AWG20

P/N: 23HT22-5503S
 1.2deg 5.5A 1Nm
 S/N: XXXXXXXXXXXXX



MOTOR CONNECTION			
PIN NO	BIPOLAR	LEADS	WINDING
1	U	GRN	
2	V	RED	
3	W	BLU	

CONNECTION	BIPOLAR
SPECIFICATION	
PHASE	3
AMPS/PHASE	5.50
RESISTANCE/PHASE(Ohms)@25°C	0.45±10%
INDUCTANCE/PHASE(mH)@1KHz	0.98±20%
HOLDING TORQUE(Nm)[lb-in]	1.00 [8.86]
STEP ANGLE(°)	1.20
STEP ACCURACY(NON-ACCUM)	±5.00%
ROTOR INERTIA(g-cm²)	280
WEIGHT(Kg)[lb]	—
AMBIENT TEMPERATURE	0°C~50°C[32°F~122°F]
INSULATION CLASS	B 130°C[266°F]
TEMPERATURE RISE	MAX.80°C

EXCITATION SEQUENCE, WHEN FACING MOUNTING END (X)						
STEP	1	2	3	4	5	6
U	+	-	-	+	-	-
V	-	+	-	-	+	-
W	-	-	+	-	-	+

← CW
 CCW →

DIMENSIONS ARE IN MILLIMETERS.
 TOLERANCES AS BELOW:
 DECIMALS ANGLES
 X ±0.5 ±2°
 X.X ±0.25
 X.XX ±0.13

THIRD ANGLE PROJECTION

STEPPERONLINE®

STEPPER MOTOR

23HT32-5803S-C1

REV.	0	SCALE	2:3	DWG NO.	A2730
------	---	-------	-----	---------	-------

SIGNATURE		DATE
DRN	ZPJ	7.30.2025
APVD	YSX	7.30.2025