

SPECIFICATION	CONNECTION	VALUE
GEAR RATIO		20
EFFICIENCY		90.00%
BACKLASH@NO-LOAD(arcmin)		<=50
MAX.PERMISSIBLE TORQUE(Nm)[lb-in]		10.00[88.51]
SHAFT MAXIMUM AXIAL LOAD(N)		80
SHAFT MAXIMUM RADIAL LOAD(N)		260
GEARBOX MATCHING MOTOR'S INPUT SHAFT LENGTH (mm)		9.5±0.5
NOISE(dB)		<=55
WATERPROOF RATING		IP54
AMBIENT TEMPERATURE		-10°C~90°C[14°F~194°F]

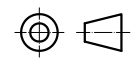

STEPPERONLINE®

	APVD		10.21.2021
	CHKD		
1:1	DRN		
SCALE	SIGNATURE		DATE

PLANETARY GEARBOX

PLM17-G20