

SPECIFICATION	VALUE
No. of PHASE	2
AMPS/PHASE	0.5
RESISTANCE/PHASE(Ohms)@20°C	7.2±7%
INDUCTANCE/PHASE(mH)@1KHz	4.1±20%
THE MARK THRUST(N)@100PPS	30
THE MARK PILL(N)@100PPS	30
STEP ANGLE(°)	7.5±7%
LINEAR TRAVEL/STEP(mm)	0.0254
AFTER ALL JOURNEY(mm)	13.5
WEIGHT(g)[lb]	34[0.08]
PROTECTION RATE	IP30
LIFE 1,500,000 RETURN(A CYCLE)ADVANCE 13mm,BACKING OUT 13mm	
INSULATION RESISTANCE 100MΩ (WINDING TO THE CRUST)	
AMBIENT TEMPERATURE -10°C~40°C[14°F~104°F]	
INSULATION CLASS E 120°C[248°F]	
DIELECTRIC STRENGTH 650±50 VAC FOR 2 Sec.(BETWEEN THE MOTOR COILS AND THE MOTOR CASE)	

PIN No.	WIRE COLOR	STEP			
		1	2	3	4
1	BLK	-	+	+	-
2	RED	+	-	-	+
3	BLU	-	-	+	+
4	YEL	+	+	-	-
5	/				
6	/				

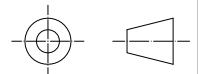
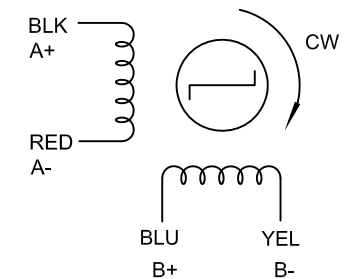

STEPPERONLINE®

	APVD		5.31.2019
	CHKD		
2:1	DRN		
SCALE	SIGNATURE		DATE

PM STEPPER MOTOR

25LN48L01-334